

OSOR katalog 2016



SYDNEY-40

- Elektronska brava
- Protupožarnost 60 minuta
- Boja - antracit

ARTIKL	NAZIV ARTIKLA	A	B	C
T05463	Sef SYDNEY 40, 38 kg	320	445	450

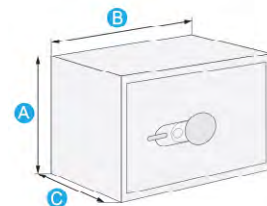

SYDNEY-55

- Elektronska brava
- Protupožarnost 60 minuta
- Boja - antracit

ARTIKL	NAZIV ARTIKLA	A	B	C
T05437	Sef SYDNEY 55, 51 kg	510	445	450

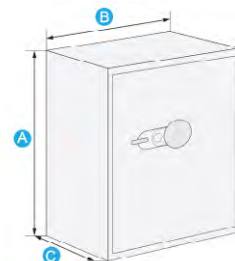

SYDNEY-65

- Elektronska brava
- Protupožarnost 60 minuta
- Boja - antracit

ARTIKL	NAZIV ARTIKLA	A	B	C
T05438	Sef SYDNEY 65, 86 kg	715	485	475

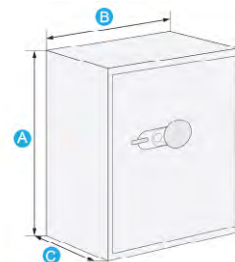

SYDNEY-140

- Elektronska brava
- Protupožarnost 60 minuta
- Boja - antracit

ARTIKL	NAZIV ARTIKLA	A	B	C
T05439	Sef SYDNEY 140, 310 kg	1385	710	475



OSOR katalog 2016



FIRECHAMP PREMIUM

- Sigurnosni protupožarni sef, debljine vrata 92 mm
- 30 minuta na 1090°C
- Sefovska ili elektronska brava

ARTIKL	NAZIV ARTIKLA	A	B	C
T05015	FireChamp 30, 49 kg	300	427	385
T05017	FireChamp 32, 52 kg	315	445	440
T05019	FireChamp 45, 68 kg	460	440	440
T05021	FireChamp 50, 62 kg	490	360	440
T05023	FireChamp 65, 91 kg	670	440	440
T05025	FireChamp 100, 120 kg	950	440	440

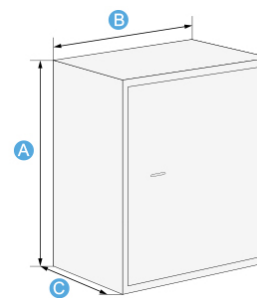

FORTFIRE

- Sef ima dvostruku čeličnu konstrukciju korpusa debljine 70 mm
- Vatrootpornost 1 sat na 927°C
- Elektronska brava sa funkcijom odgode otvaranja (time-delay) 0-99 min

ARTIKL	NAZIV ARTIKLA	A	B	C
18178	F-200, 207 kg	670	550	550
18179	F-250, 240 kg	850	550	550
18180	F-300, 317 kg	1015	550	550
18181	F-500, 485 kg	1500	600	550

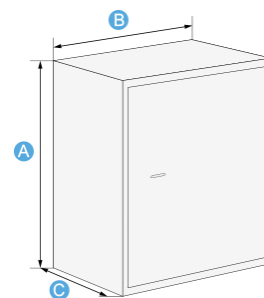

OFFICE PREMIUM

- Protupožarni ormar izrađen od visokokvalitetnog čelika, sa duplom stijenkom debljine 60 mm
- Sefovska brava sa dva ključa EN1300, Class A
- Office 1 i 2 su jednokrilni ormari, 3 i 4 su dvokrilni

ARTIKL	NAZIV ARTIKLA	A	B	C
T05029	Office-1, 71 kg	1220	600	520
T05031	Office-2, 90 kg	1220	930	520
T05033	Office-3, 142 kg	1950	930	520
T05035	Office-4, 200 kg	1950	1250	520

